

24" ABOVE LIQUID MANHOLE 6 3/8" TALL

(24) 9/16" DIA. HOLE
ON 27" BOLT CIRCLE

3 4 5

28 1/2" DIA. COVER

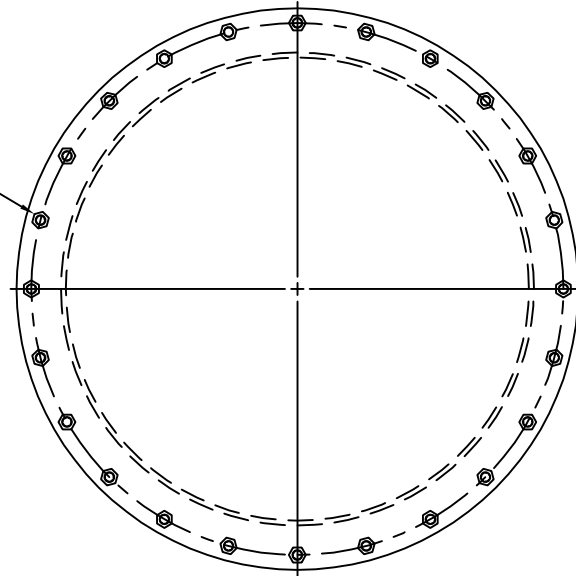

TOP VIEW

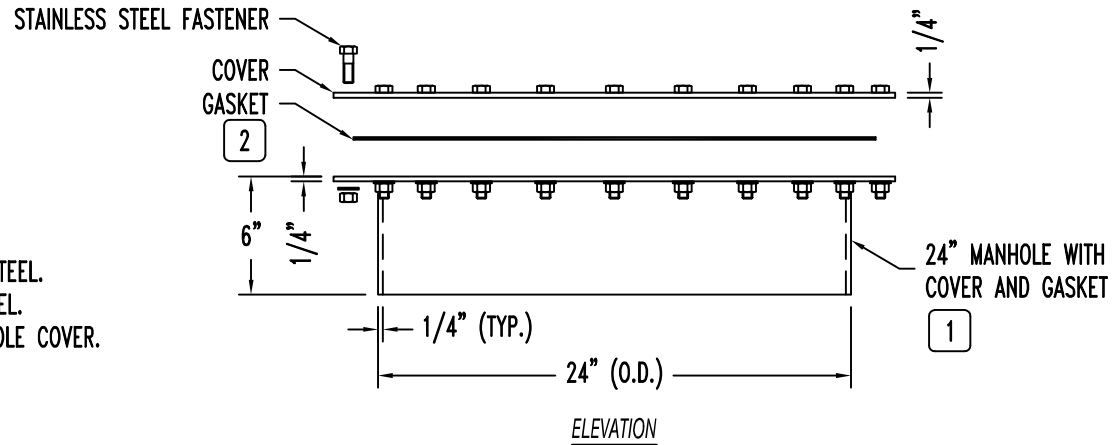

ELEVATION

NOTES:

1. MANHOLE ASSEMBLY SHALL BE CARBON STEEL.
2. ALL FASTENERS SHALL BE STAINLESS STEEL.
3. GASKET SHALL BE INSTALLED WITH MANHOLE COVER.
4. GASKET SPECIFICATIONS:
CORK AND NITRILE RUBBER
1/8" THK. X 24" I.D. X 28 1/2" O.D.
5. EXTERIOR COATING SHALL BE THE SAME AS TANK, UNLESS NOTED.

PRODUCT CODE	GALLONS	DESCRIPTION	OVERALL SIZE	SHIP WT.
MHB006		24" ABOVE LIQUID MANWAY	28 1/2" DIA. X 6" H	

CONTAINMENT SOLUTIONS

THIS DRAWING AND DESIGN SHOWN HEREIN IS THE PROPERTY OF CONTAINMENT SOLUTIONS. USE OR COPIES THEREOF CANNOT BE MADE WITHOUT WRITTEN CONSENT.

CUSTOMER NAME: _____
APPROVED BY: _____ DATE: _____

DRAWN BY: D. ROVANG		DATE DRAWN: 01-01-14	
DWG NUMBER: MHB006		SCALE:	
REV:	REV BY:	DATE:	SHEET: 1 OF 1